



SolarEdge TerraMax™ Inverter

Quick Installation Guide

For Europe, APAC,
and South Africa
Version 1.6

Scan for full Installation Guide



Legend



NOTE

This symbol denotes information intended to assist the user in making optimum use of the product.



CAUTION!

Denotes a hazard. It calls attention to a procedure that, if not correctly performed or adhered to, could result in damage or destruction of the product. Do not proceed beyond a caution sign until the indicated conditions are fully understood and met.



WARNING!

Denotes a hazard. It calls attention to a procedure that, if not correctly performed or adhered to, could result in injury or loss of life. Do not proceed beyond a warning note until the indicated conditions are fully understood and met.



Do not cut the cable connectors



Do not bend the cable. Bending radius: 4 x wire diameter.



This symbol appears at grounding points on the SolarEdge manuals and equipment.

SAVE THESE INSTRUCTIONS – This guide contains important instructions for SolarEdge TerraMax Inverter that should be followed during installation and maintenance. Using this equipment in a manner not specified in this guide by SolarEdge may impair the protection provided by this equipment.

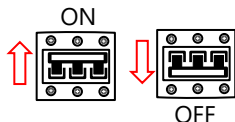

Turn ON/OFF the main circuit board AC switch. When turning it off, wait 5 minutes for DC Voltage to drop to a safe level before removing the front panel.

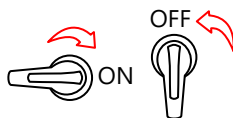

Turn the DC Disconnect Switch on/off. (Switch is available for some models) When turning it off, wait 5 minutes for DC Voltage to drop to a safe level before removing the front panel.

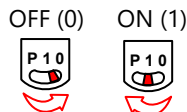

Turn the ON/OFF/P Switch on/off. When turning it off, wait 5 minutes for DC Voltage to drop to a safe level before removing the front panel.



Before connecting aluminum wires to terminals:

1. Remove oxide from the exposed wires with emery paper or a steel wire brush
2. Clean dust with a cloth and Isopropyl alcohol (IPA)
3. Coat wires with a designated antioxidant aluminum wire grease immediately after cleaning



CAUTION! Connection of oxidized aluminum wires may result in resistance and high temperatures at contact points. Improper execution of the following procedure may cause damage to the unit.



Before installation, read the **HANDLING AND SAFETY INSTRUCTIONS**



Installing the Power Optimizers

1

1 → 2 → 3 → 4 → 5 → 6

1

Use SolarEdge Designer
to create and design SE system
<https://designer.solaredge.com>

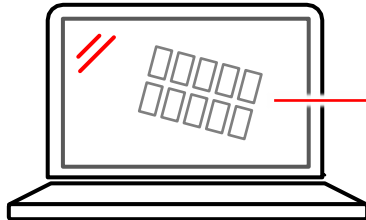

2

Create a new site in Monitoring
Platform and import PV layout
from SolarEdge Designer
<https://monitoring.solaredge.com/solaredge-web/p/login>

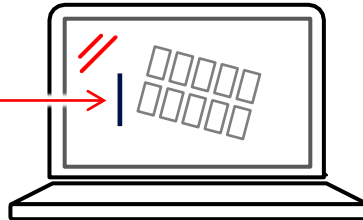

3

Download SolarEdge Mapper
to map string Power Optimizers



1

Installing the Power Optimizers

① → ② → ③ → ④ → ⑤ → ⑥

④

Install the H1300 Power Optimizer

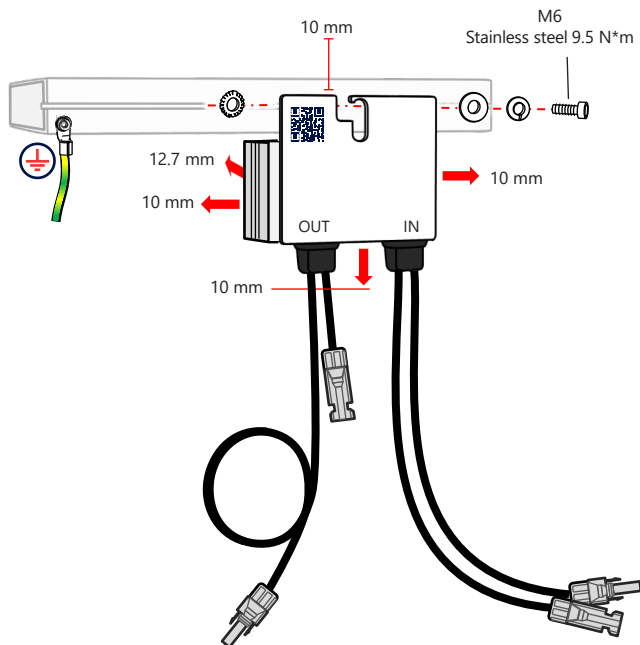

⑤

Scan QR code using Mapper

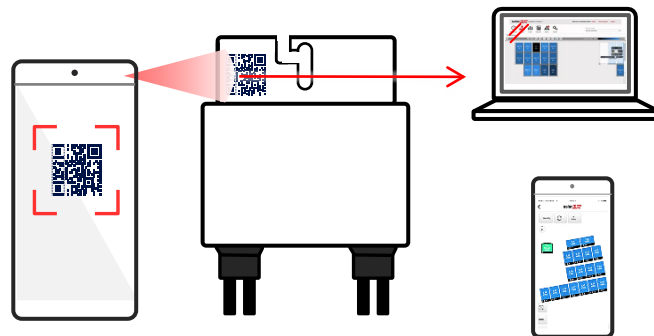

Complete site registration and
physical layout in the
Monitoring platform

Connecting the Power Optimizers

1 → 2 → 3 → 4 → 5 → 6

1



CAUTION! Do not sharply bend the DC cables. Keep proper bending radius to avoid cable break. Do not use stretched cabling. Using only MC4 connectors compatible with the Power optimizer.

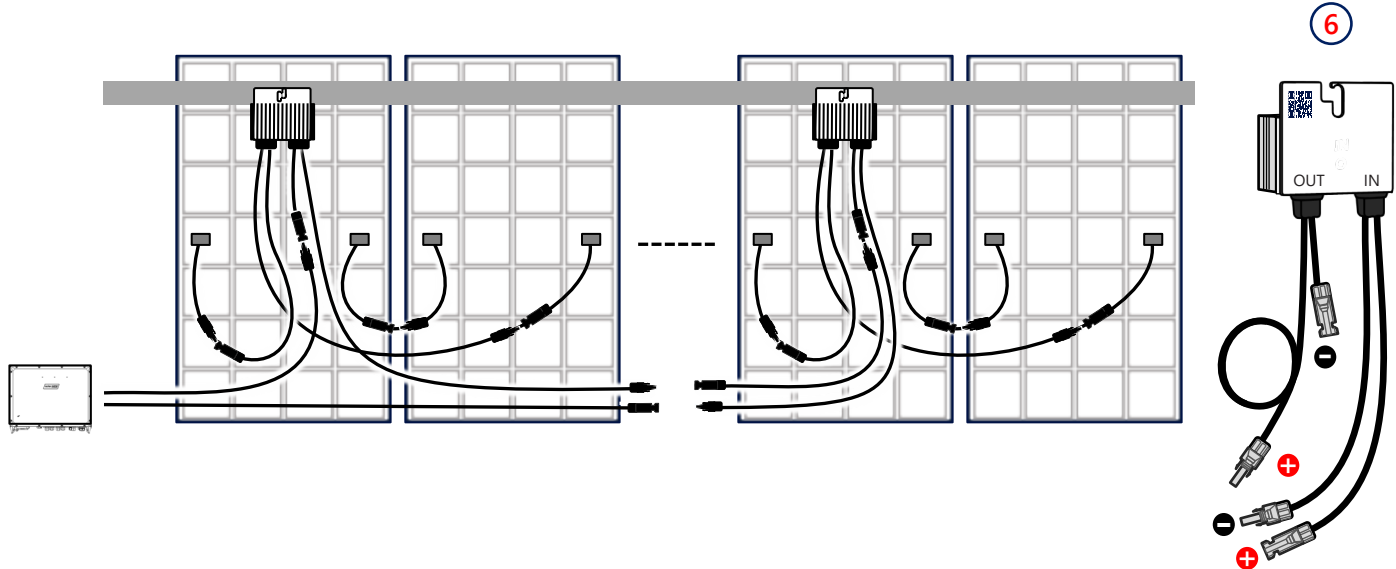

2

Connecting PV Strings

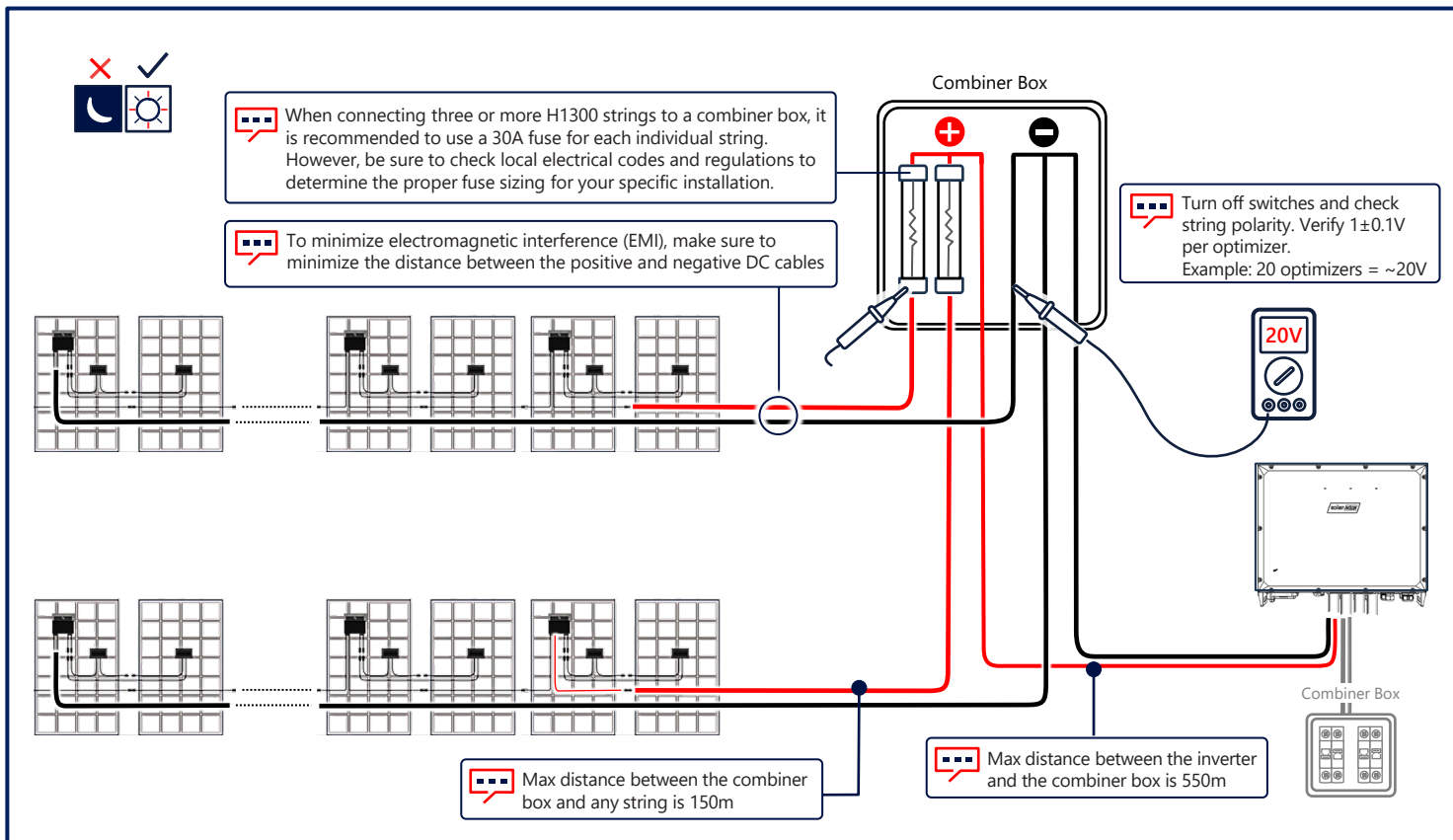

Maintaining Clearance

3

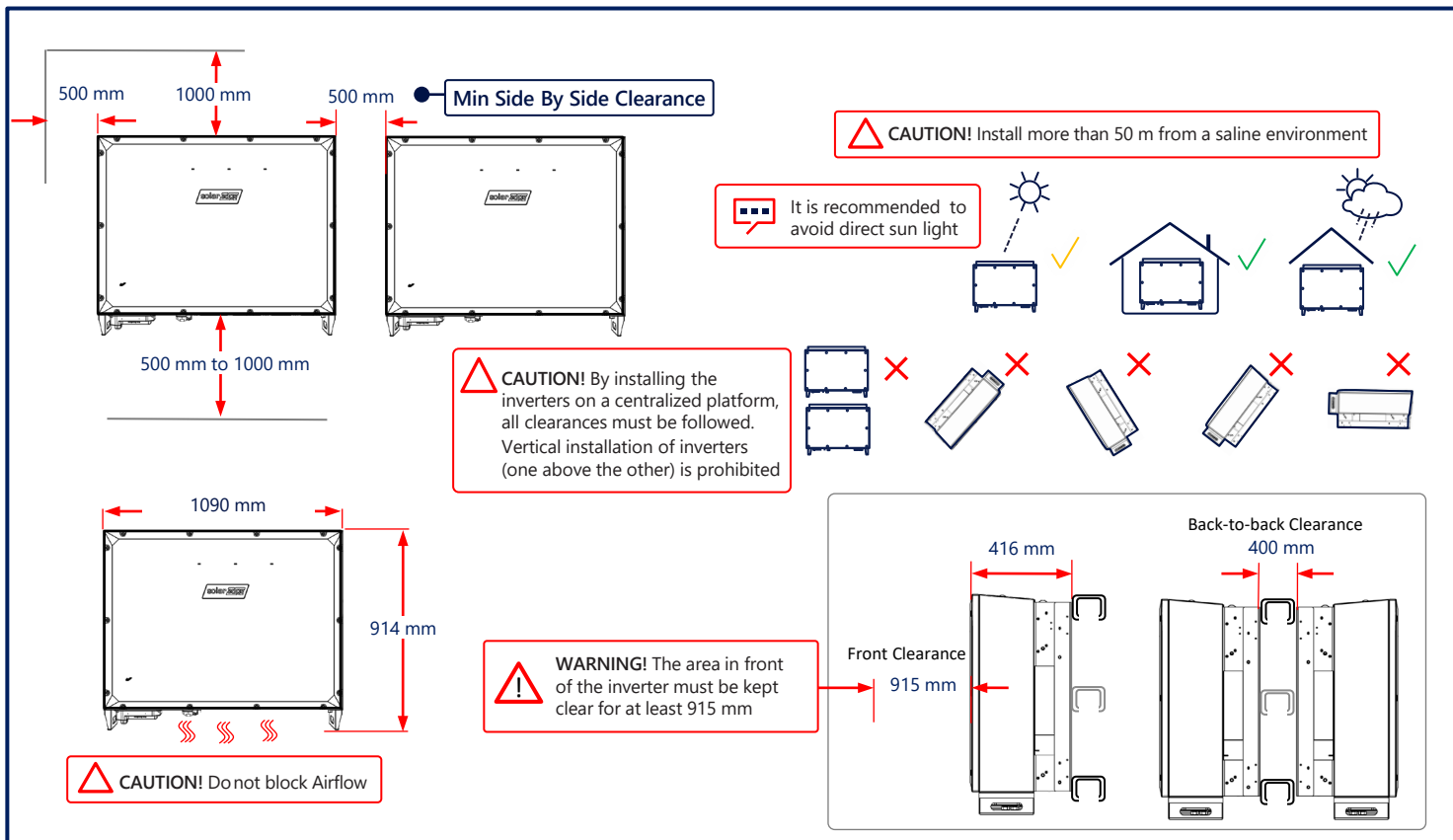

4 Mounting

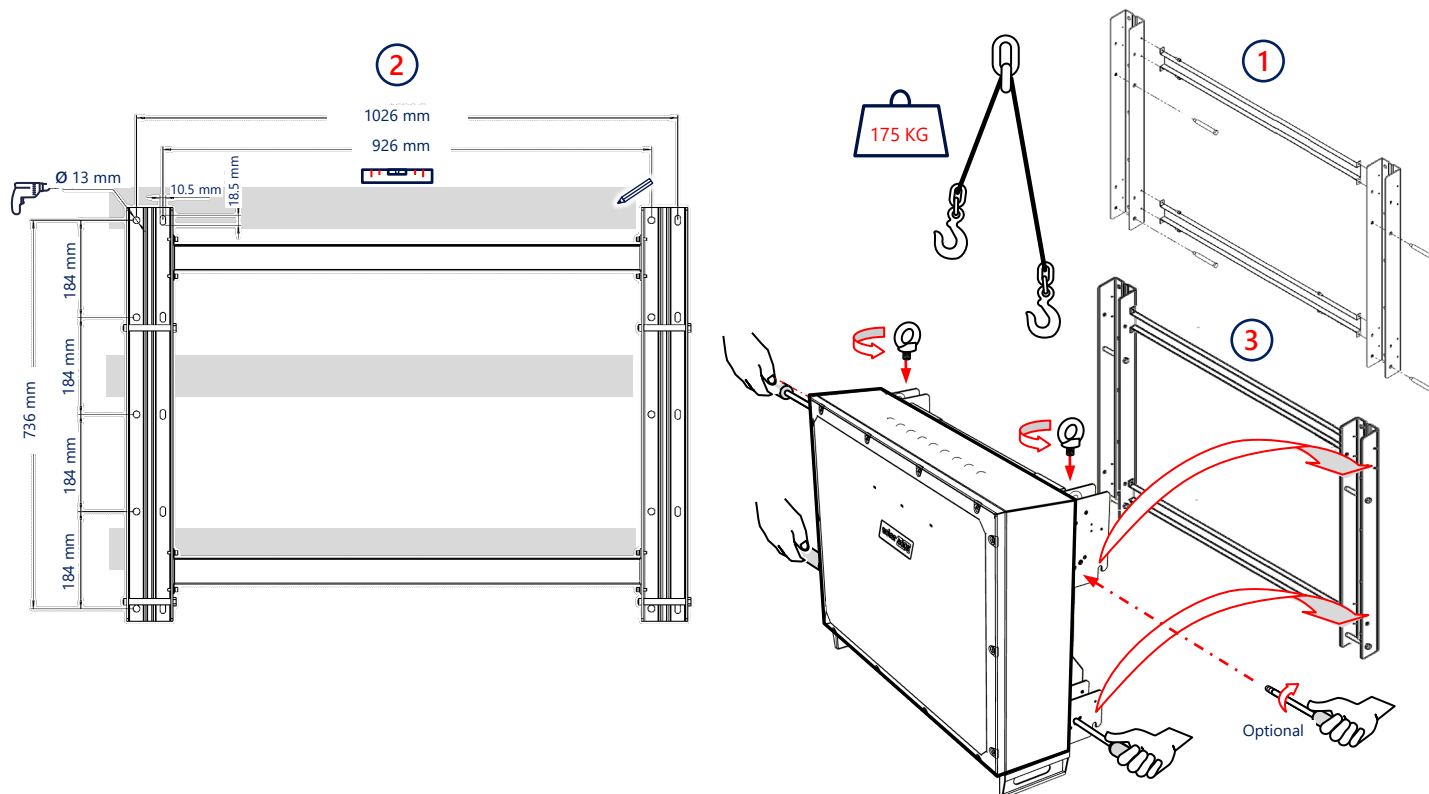

Removing Covers and Chassis Ground



WARNING

DISCONNECT POWER BEFORE
REMOVING COVERS

1



OFF (0)

2



OFF

3

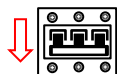

OFF

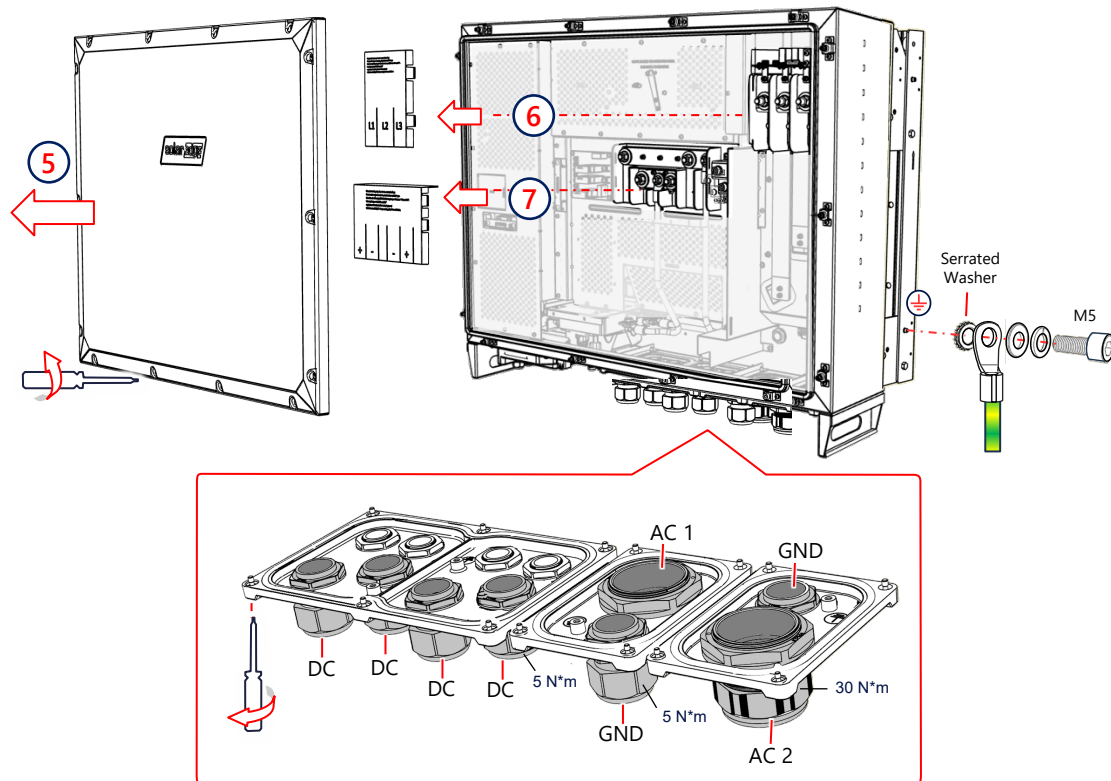

6 Connecting the PV Arrays

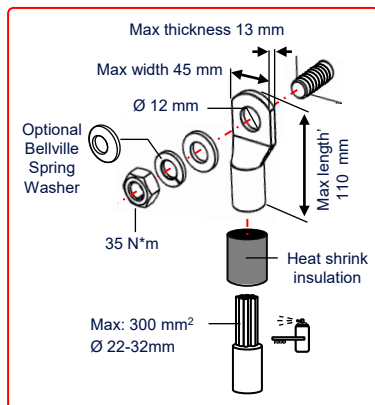

⚠ CAUTION!

- For aluminum cables: Use Al/Cu (bi-metal) lugs or aluminum lugs with bi-metal washers. Place the bi-metal washer between the aluminum lug and the inverter bus bar, copper side facing the bus bar.
- For copper cables: Use only copper tin-plated lugs.



One-hole, standard barrel, compression lugs only



Use AC cables with 90°C Cu / Al wires
Use outdoor copper core PE wires

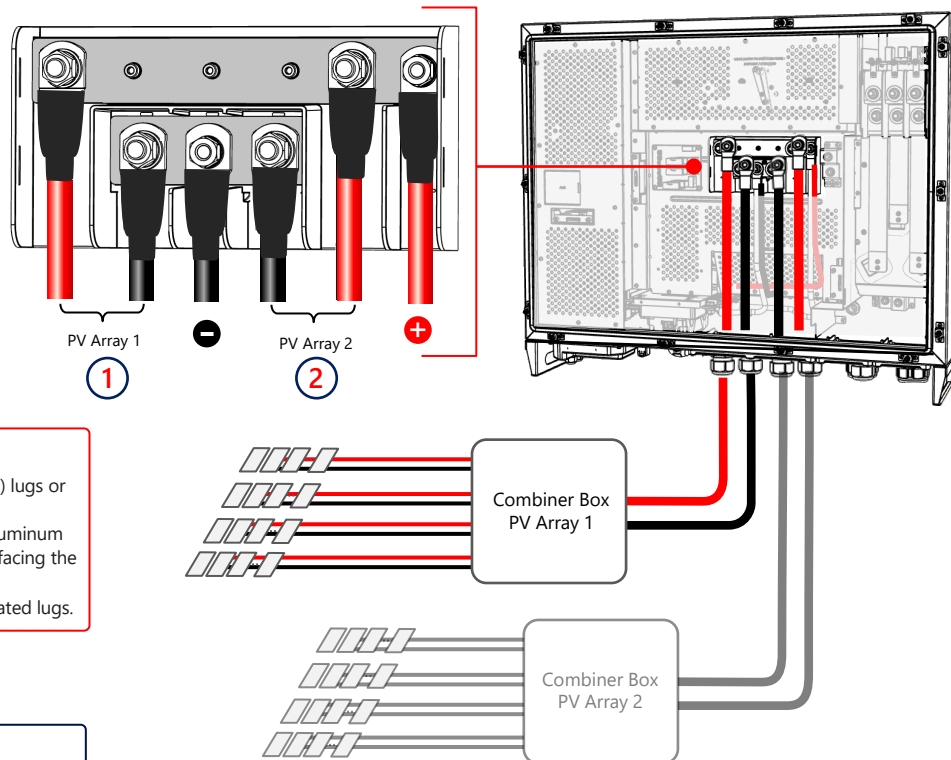

Connecting AC and Protective Earth (PE)

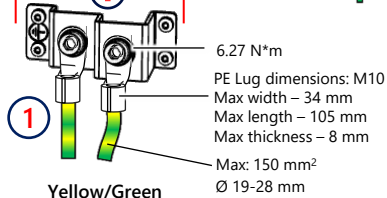
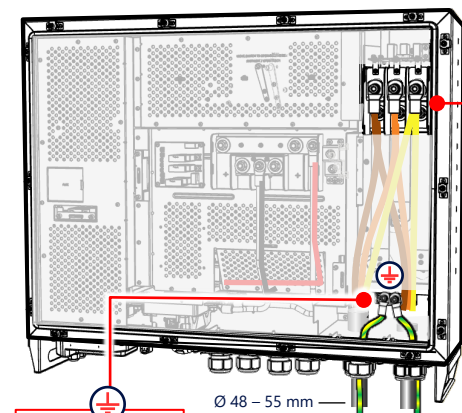

CAUTION! First, connect the Protective Earth (PE) wire

Use AC cables with 90°C Cu / Al wires
Use outdoor copper core PE wires

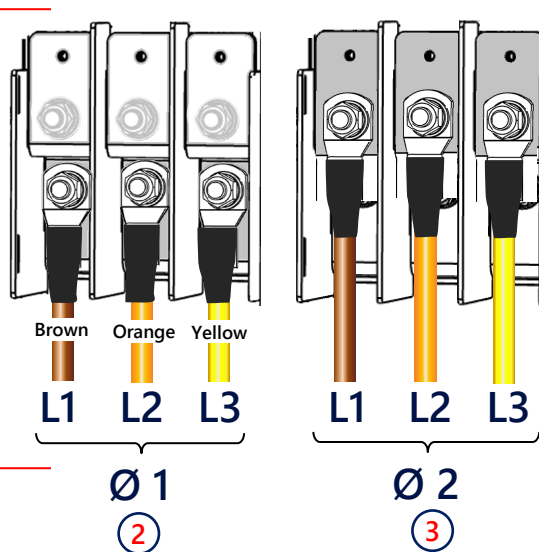

Overcurrent protection for the AC output must be provided by others. See full installation guide for guidance

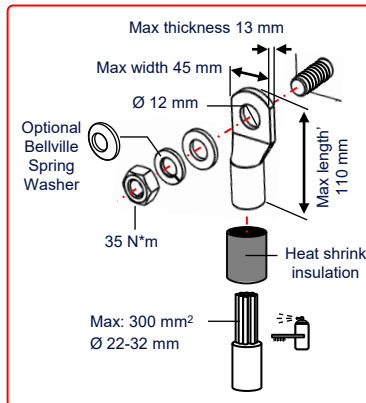

CAUTION!

- For aluminum cables: Use Al/Cu (bi-metal) lugs or aluminum lugs with bi-metal washers. Place the bi-metal washer between the aluminum lug and the inverter bus bar, copper side facing the bus bar.
- For copper cables: Use only copper tin-plated lugs.

One-hole, standard barrel, compression lugs only

8

Accessing the Communication Compartment

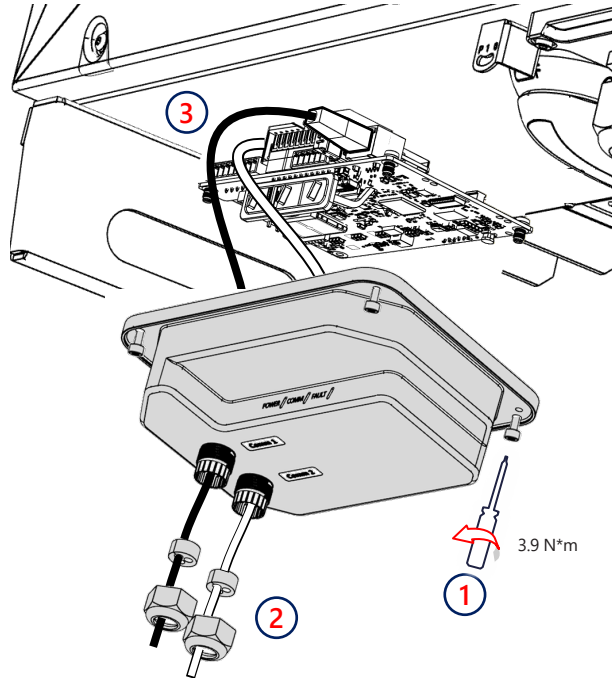

Connecting Communication

9

CAN Bus (for connection between inverters)

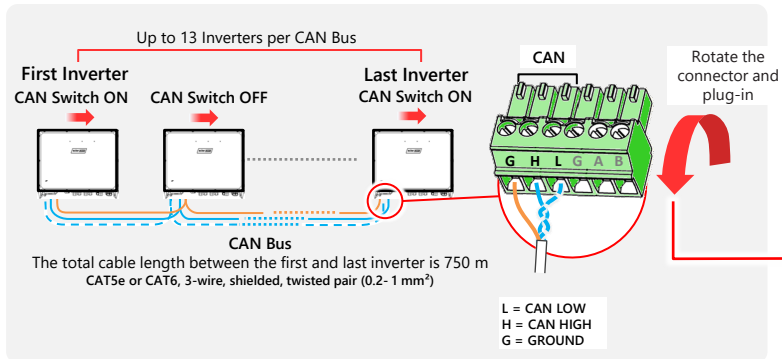

IMPORTANT! DO NOT connect inverters other than SolarEdge TerraMax Inverters.

IMPORTANT! Move the CAN Switch of the first and last inverters on the bus to ON position.

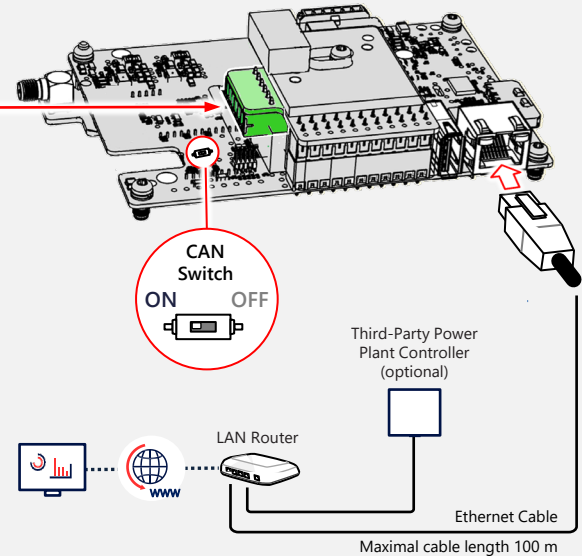

RS-485 Bus (for connecting third-party devices such as meter or PPC)

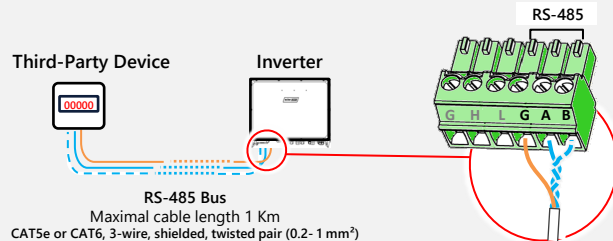

10 Unlocking Relays and Installing the Covers

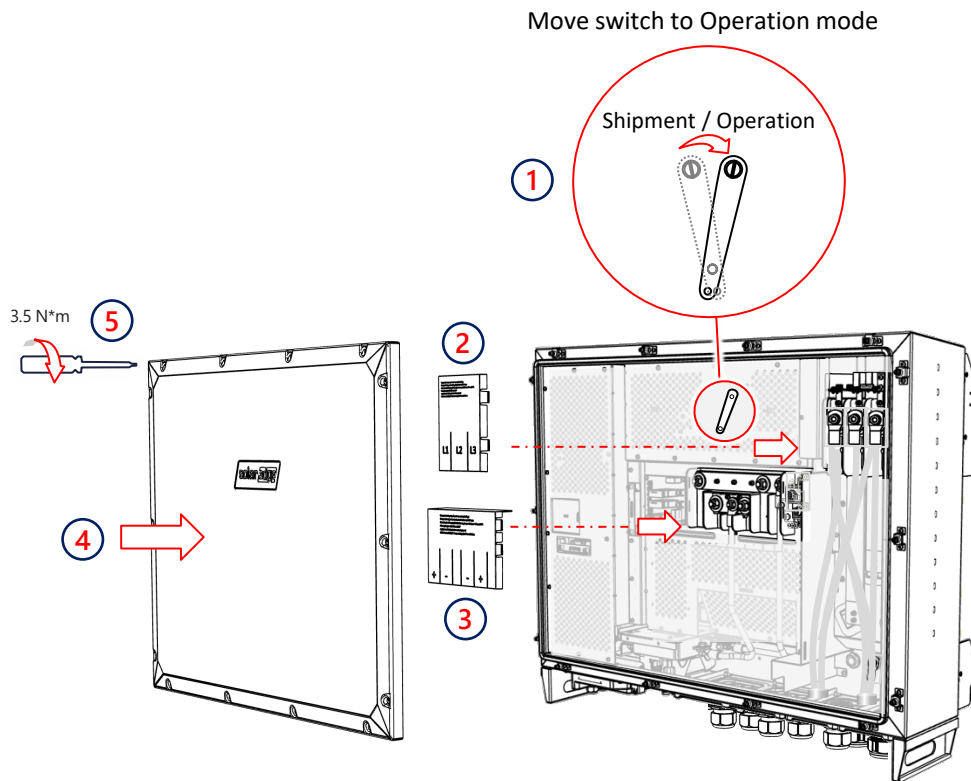

Commissioning (Part 1)

11

1
Download
SolarEdge SetApp



Commissioning when connected to AC from Grid



Commissioning when connected only to DC from PV Array

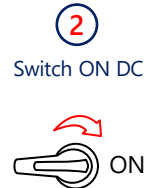

12

Commissioning (Part 2)

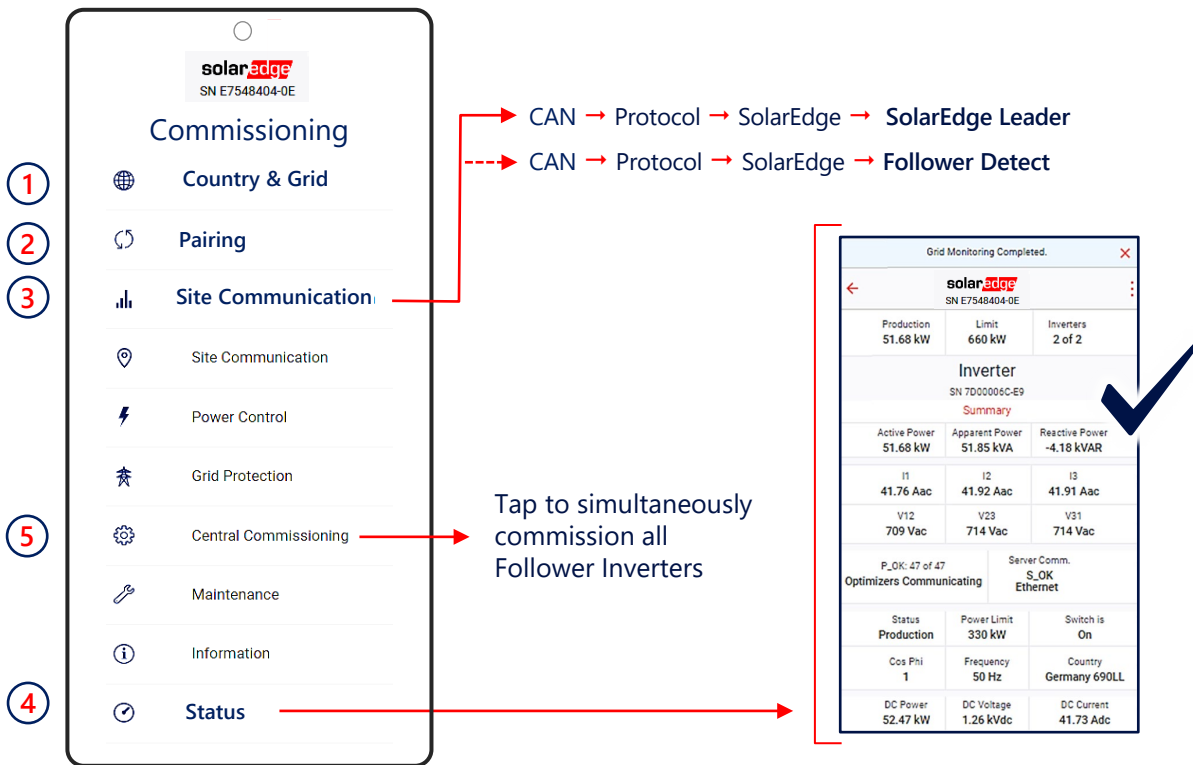

LED Indications

13



For detailed Status and System
Performance LED Indications:
<https://www.solaredge.com/leds>

POWER COMM FAULT

Green

Blue

Red



System is producing Power



AC is connected but the system is not producing power



Inverter is communicating with the Monitoring platform



System error

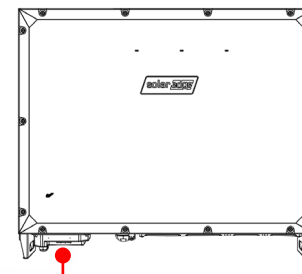
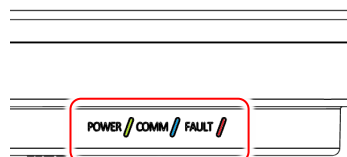



Support Contact Information

If you have technical problems concerning SolarEdge products, please contact us:

<https://www.solaredge.com/service/support>

Subject to change without notice.

Copyright © SolarEdge Inc.

All rights reserved. August 2024.



MAN-01-01066-1.6